

# Flag Banners

## INSTRUCTIONS

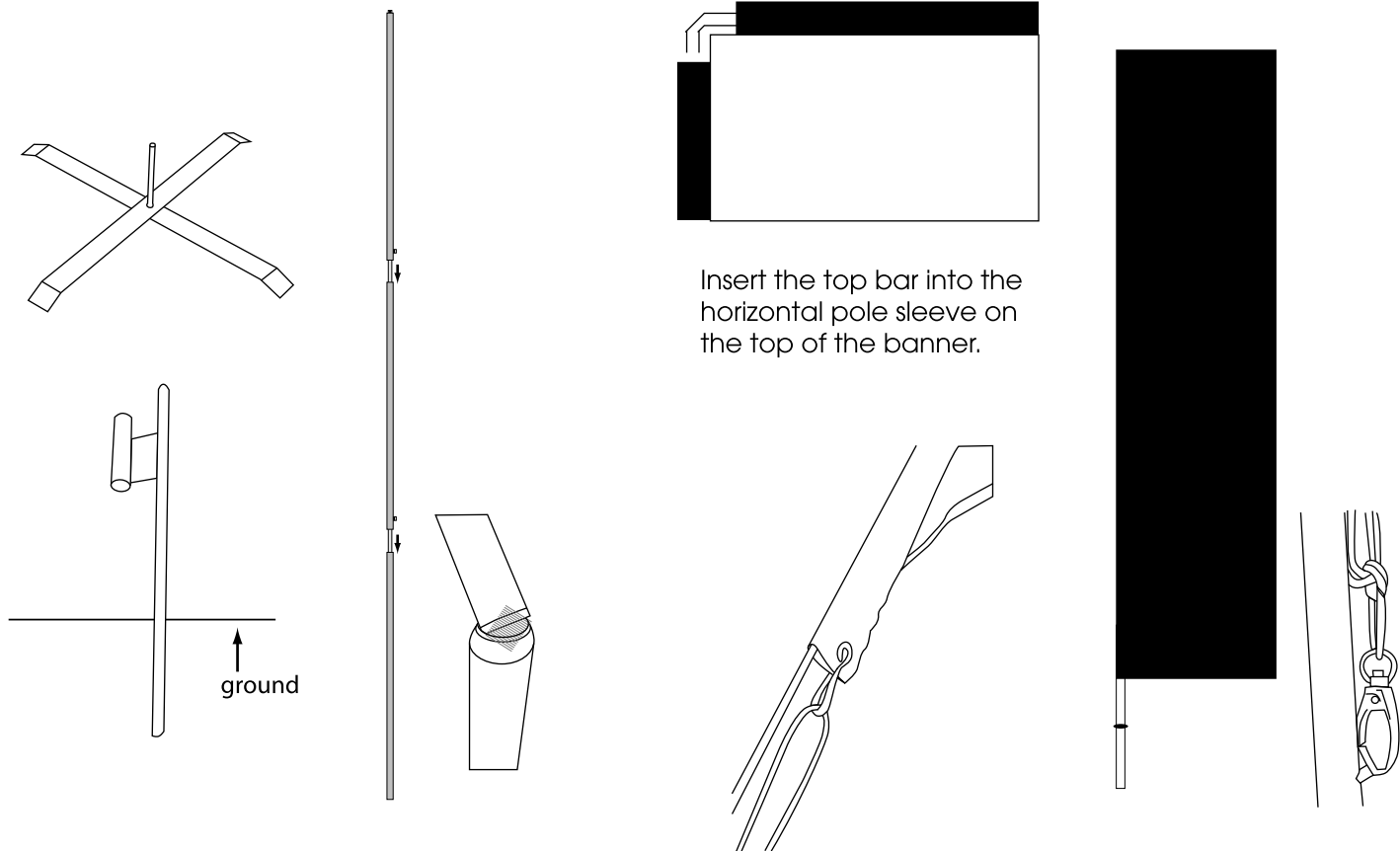

Place mounting option in desired location.

Assemble the individual pole segments into one long section.

Carefully slide the fabric banner sleeve over the poles until a connection is made with the upper horizontal bar.

Attach the banner to the pole clip and place it on the mounting option.

Note: Aggressively forcing or jamming the poles into the banner could cause damage to the banner. Such damage is not covered under warranty.

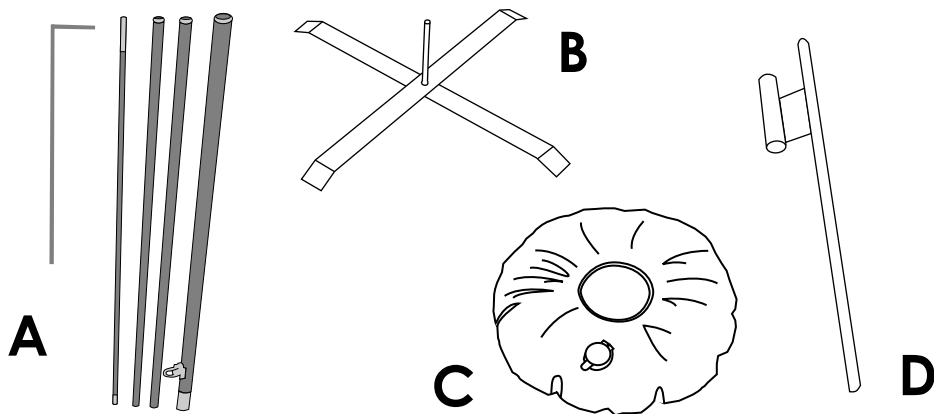

- A. Aluminum Poles
- B. Hard Surface Stand
- C. Weight Bag
- D. Ground Stake